

COPPER CABLE LUGS



*Manufactured to the accepted Australian dimension
from 99.9% IACS

* oxygen free copper - electro tinned finish to BS1572 (1984)

*Suitable for standard copper conductors - Range 0.5 - 1000mm²

*Seamless copper tube *Cable size clearly identified on the lug

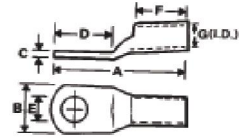
*Tested to AS/NZS 4325.1:1995



PART No.	H CAT No.	CABLE SIZE mm ²	STUD SIZE	DIMENSIONS (mm ²)						No. of CRIMPS (Tool)								CRIMP DIE	PACK QTY
				A	B	C	D	F	G	76	00	18	20	21	22	38A			
CG0.5M4	H1399	0.5	M4	17.5	6.4	1.4	9.5	6.0	2.1	-	-	-	-	-	-	-	-	100	
CG0.5M4	H1400		M4	19.1	6.4	1.4	11.1	6.0	2.1	1	1	1	-	-	-	-	-	100	
CG0.55M5	H1401S		M5	19.1	8.7	1.0	11.1	6.0	2.1	1	1	1	-	-	-	-	-	100	
CG0.5LM5	H1401L		M5	26.6	8.7	1.0	15.1	9.5	2.1	2	2	1	-	-	-	-	-	100	
CG0.5M6	H1402		M6	26.2	10.3	0.9	15.1	9.5	2.1	2	2	1	-	-	-	-	-	100	
CG0.5M8	H1402A		M8	26.2	11.1	0.8	15.1	9.5	2.1	2	2	1	-	-	-	-	-	100	
CG2.5M4	H1436A	2.5	M4	21.4	9.1	1.1	11.9	8.0	2.5	2	1	1	-	-	-	-	-	100	
CG2.5M5	H1436		M4	21.4	9.1	1.1	11.9	8.0	2.5	2	1	1	-	-	-	-	-	100	
CG2.5M6	H1437		M5	26.2	10.3	0.9	15.1	8.7	2.5	2	2	1	-	-	-	-	-	100	
CG2.5LM8	H1437A		M5	26.2	10.3	0.9	15.1	8.7	2.5	2	2	1	-	-	-	-	-	100	
CG4SM5	H1403S	4	M5	21.0	8.7	1.5	11.1	8.0	3.3	2	1	1	-	-	-	-	-	100	
CG4LM5	H1402A		M5	27.3	8.7	1.5	14.7	9.2	3.3	2	2	1	-	-	-	-	-	100	
CG4M6	H1404		M6	27.8	10.3	1.2	15.1	9.5	3.3	2	2	1	-	-	-	-	-	100	
CG4M8	H1404A		M8	28.6	13.0	1.0	13.3	9.5	3.3	2	2	1	-	-	-	-	-	100	
CG4M10	H1404B		M10	28.6	13.0	1.0	16.3	9.5	3.3	2	2	1	-	-	-	-	-	100	
CG6M6	H1405		6	M6	27.0	10.3	1.2	15.0	9.5	3.7	-	2	1	-	1	1	1	-	100
CG6M8	H1405A	M8		28.6	13.9	0.9	16.7	9.5	3.7	-	2	1	-	1	1	1	38-44CU	100	
CG6M10	H1405B	M10		28.6	13.9	0.9	16.7	9.5	3.7	-	2	1	-	1	1	1	-	100	
CG10SM6	H1406S	10	M6	27.0	11.9	1.8	15.5	9.5	4.7	-	2	1	-	1	1	1	-	50	
CG10LM6	H1406L		M6	29.4	11.9	1.8	15.5	11.5	4.7	-	2	2	-	1	1	1	-	50	
CG10M8	H1406A		M8	28.6	14.3	1.6	16.3	9.5	4.7	-	2	1	-	1	1	1	38-57CU	50	
CG10M10	H1406B		M10	30.6	14.3	1.6	16.3	9.5	4.7	-	2	1	-	1	1	1	-	50	
CG10M12	H1406C		M12	33.0	17.0	1.4	20.0	11.0	4.7	-	2	1	-	1	1	1	-	50	
CG16M5	H1407A	16	M5	39.7	11.6	2.3	16.3	20.6	5.5	-	-	3	2	2	2	1	-	50	
CG16M6	H1407		M6	39.7	11.6	2.3	16.3	20.6	5.5	-	-	3	2	2	2	1	-	50	
CG16M8	HG1408		M8	39.7	13.5	1.9	16.3	20.6	5.5	-	-	3	2	2	2	1	38-63CU	50	
CG16M10	H1408A		M10	41.5	13.5	1.9	18.5	20.6	5.5	-	-	3	2	2	2	1	-	50	
CG16M11	H1445		M11	43.6	16.7	2.8	19.0	22.2	5.5	-	-	-	2	2	2	1	38-77CU	50	
CG16M12	H1408B		M12	46.0	17.5	1.4	20.5	19.0	5.5	-	-	-	2	2	2	1	38-63CU	50	
CG20M6	H1409	20	M6	34.9	12.5	2.3	14.3	19.0	6.3	-	-	-	2	2	2	1	-	100	
CG20M8	H1410		M8	42.1	13.5	2.2	19.0	20.3	6.3	-	-	-	2	2	2	1	-	100	
CG20M10	H1411		M10	42.1	14.3	2.0	19.0	20.3	6.3	-	-	-	2	2	2	1	38-70CU	100	
CG20M12	H1411A		M12	42.1	15.2	1.9	19.0	20.3	6.3	-	-	-	2	2	2	1	-	100	
CG25M6	H1415A	25	M6	43.6	16.7	2.2	19.0	22.0	7.1	-	-	-	2	2	2	1	-	50	
CG25M8	H1415		M8	43.6	16.7	2.2	19.0	22.0	7.1	-	-	-	2	2	2	1	-	50	
CG25M10	H1416		M10	43.6	16.7	1.9	19.0	22.0	7.1	-	-	-	2	2	2	1	38-77CU	50	
CG25M11	H1416A		M11	43.6	16.7	1.9	19.0	22.0	7.1	-	-	-	2	2	2	1	-	50	
CG25M12	H1416B		M12	51.0	18.2	1.7	25.4	21.0	7.1	-	-	-	2	2	2	1	-	50	
CG35M6	H1365	35	M6	43.6	18.2	2.7	19.0	22.2	8.4	-	-	-	2	2	2	1	-	50	
CG35M8	H1366		M8	43.6	18.2	2.7	19.0	22.2	8.4	-	-	-	2	2	2	1	-	50	
CG35M10	H1368		M10	43.6	18.2	2.7	19.0	22.2	8.4	-	-	-	2	2	2	1	-	50	
CG35M12	H1369		M12	51.2	20.0	2.4	24.5	22.0	8.4	-	-	-	2	2	2	1	38-92CU	50	
CG3535M11	H1442		M11	51.6	19.0	3.7	27.0	22.2	8.7	-	-	-	2	2	2	1	38-104CU	50	
CG50M8	H1419		50	M8	51.6	18.2	3.1	27.0	22.2	9.5	-	-	-	2	2	2	1	-	25
CG50M10	H1420	M10		51.6	19.0	3.0	27.0	22.2	9.5	-	-	-	2	2	2	1	38-104CU	25	
CG50M12	H1421	M12		51.6	20.6	2.8	27.0	22.2	9.5	-	-	-	2	2	2	1	-	25	
CG70M6	H1422B	70	M6	54.0	20.6	3.2	27.0	23.0	11.0	-	-	-	2	-	2	1	-	25	
CG70M8	H1422A		M8	54.0	20.6	3.2	27.0	23.0	11.0	-	-	-	2	-	2	1	-	25	
CG70M10	H1422		M10	54.0	20.6	3.2	27.0	23.0	11.0	-	-	-	2	-	2	1	38-115CU	25	
CG70M12	H1423		M12	54.0	20.6	3.2	27.0	23.0	11.0	-	-	-	2	-	2	1	-	25	
CG70M16	H1423A		M16	54.2	27.5	2.4	27.0	22.0	11.0	-	-	-	2	-	2	1	-	25	
CG70M11	H1443		M11	54.0	22.2	4.7	27.0	23.0	11.2	-	-	-	2	-	2	1	38-130CU	25	
CG70M20	H1439		M20	76.0	28.6	3.5	45.0	25.4	11.0	-	-	-	-	-	-	1	38-142CU	25	
				Is H1438 sleeved to suit 19/20/21															

COPPER CABLE LUGS																
PART No.	H CAT No.	CABLE SIZE mm ²	STUD SIZE	DIMENSIONS (mm ²)						No. of CRIMPS (Tool)						PACK QTY
				A	B	C	D	F	G	20	21	22	38A	40B	CRIMP DIE	
CG95M6	H1424B	95	M6	57.2	25.4	4.0	27.0	27.0	13.4	2	-	2	1	1	38-142CU 40-142CU	25
CG95M8	H1424C		M8	57.2	25.4	4.0	27.0	27.0	13.4	2	-	2	1	1		25
CG95M10	H1424		M10	57.2	25.4	4.0	27.0	27.0	13.4	2	-	2	1	1		25
CG95M12	H1425		M12	57.2	25.4	4.0	27.0	27.0	13.4	2	-	2	1	1		25
CG95M16	H1440		M16	75.5	27.0	3.7	45.0	25.4	13.4	2	-	2	1	1		25
CG95M20	H1438		M20	75.5	28.6	3.5	45.0	25.4	13.4	2	-	2	1	1		25
CG120M10	H1381	120	M10	68.3	30.0	4.8	31.8	31.0	15.5	-	-	2	2	1	38-165CU 40-165CU	25
CG120M12	H1382		M12	68.3	30.0	4.8	31.8	31.0	15.5	-	-	2	2	1		25
CG120M16	H1383		M16	68.3	30.0	4.8	31.8	31.0	15.5	-	-	2	2	1		25
CG120M20	H1382B		M20	68.3	30.0	4.8	31.8	31.0	15.5	-	-	2	2	1		25
CG150M10	H1384A	150	M10	75.0	33.5	5.4	41.3	27.0	16.3	-	-	-	2	1	38-183CU 40-185CU	20
CG150M12	H1384		M12	75.0	33.5	5.4	41.3	27.0	16.3	-	-	-	2	1		20
CG150M16	H1385		M16	75.0	33.5	5.4	41.3	27.0	16.3	-	-	-	2	1		20
CG150M20	H1386		M20	75.0	33.5	5.4	41.3	27.0	16.3	-	-	-	2	1		20
CG185M10	H1387A	185	M10	79.0	36.5	5.2	41.3	31.0	18.4	-	-	-	2	1	38-200CU 40-200CU	20
CG185M12	H1387		M12	79.0	36.5	5.2	41.3	31.0	18.4	-	-	-	2	1		20
CG185M16	H1388		M16	79.0	36.5	5.2	41.3	31.0	18.4	-	-	-	2	1		20
CG185M20	H1389		M20	79.0	36.5	5.2	41.3	31.0	18.4	-	-	-	2	1		20
CG240MB	H1390	240	MB	127.0	41.6	7.1	54.0	47.6	21.2	-	-	-	3	1	38-231CU 40-231CU	1
CG240M10	H1390D		M10	127.0	41.6	7.1	54.0	47.6	21.2	-	-	-	3	1		1
CG240M12	H1390A		M12	127.0	41.6	7.1	54.0	47.6	21.2	-	-	-	3	1		1
CG240M16	H1390B		M16	127.0	41.6	7.1	54.0	47.6	21.2	-	-	-	3	1		1
CG240M20	H1390C		M20	127.0	41.6	7.1	54.0	47.6	21.2	-	-	-	3	1		1
CG300MB	H1391	300	MB	127.0	46.0	7.9	54.0	47.6	23.8	-	-	-	3	1	38-260CU 40-260CU	1
CG300M16	H1391A		M16	127.0	46.0	7.9	54.0	47.6	23.8	-	-	-	3	1		1
CG300M20	H1391B		M20	127.0	46.0	7.9	54.0	47.6	23.8	-	-	-	3	1		1
CG400MB	H1448	400	MB	123.0	49.6	7.9	54.0	41.3	26.9	-	-	-	-	1	40-281CU	1
CG400M16	H1448A		M16	123.0	49.6	7.9	54.0	41.3	26.9	-	-	-	-	1		1
CG400M20	H1448B		M20	123.0	49.6	7.9	54.0	41.3	26.9	-	-	-	-	1		1
CG500MB	H1449	500	MB	142.5	54.8	8.2	54.0	55.5	30.0	-	-	-	-	2	40-310CU	1
CG500M16	H1449A		M16	142.5	54.8	8.2	54.0	55.5	30.0	-	-	-	-	2		1
CG500M20	H1449B		M20	142.5	54.8	8.2	54.0	55.5	30.0	-	-	-	-	2		1
CG630MB	H1394	630	MB	146.0	63.5	11.5	54.0	58.0	33.5	-	-	-	-	2	40-370CU	1
CG800MB	H1370	800	MB	275.0	75.0	14.0	127.0	105.0	39.3	-	-	-	-	3	40-432CU	1
CG1000MB	H1371	1000	MB	295.0	85.0	16.0	125.0	110.0	44.0	-	-	-	-	3	40-480CU	1

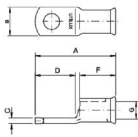

COPPER CABLE LUGS

Narrow Palm & Flared



- *Made from 99.9%+ high conductivity copper
- *Cable size clearly identified on the lug
- *Electro tinned finish
- *Can be crimped with standard Utilux Hexagonal dies



PART No.	CONDUCTOR SIZE mm ²	STUD HOLE SIZES AVAILABLE	CRIMP DIE
NARROW PALM LUGS			
 *For terminating large cables in circuit breakers			
CGNP35	35	M6	38-92CU
CGNP50	50	M6, M10	38-104CU
CGNP70	70	M6, M10	38-115CU
CGNP95	95	M8, M10	38-142CU
CGNP120	120	M8, M10	38-165CU
CGNP150	150	M8, M10	38-183CU
CGNP185	185	M10	38-200CU
CGNP240	240	M10, M12	38-231CU
CGNP300	300	M10, M12	38-260CU
FLARED LUGS			
 *For terminated multi stranded (flexible) cables			
CG25FL	25	M6, M8, M10, M12	38-77CU
CG35FL	35	M6, M8, M10, M12	38-92CU
CG50FL	50	M8, M10, M12	38-104CU
CG70FL	70	M6, M8, M10, M12	38-115CU
CG95FL	95	M6, M8, M10, M12	38-142CU
CG120FL	120	M10, M12, M16	38-165CU
CG150FL	150	M12, M16	38-183CU
CG185FL	185	M12, M16	38-200CU

COPPER CABLE LINKS

with Solid Barrier



- *For use with oil filled cables
- *Solid drawn copper tube *Electro tinned
- *Solid centre barriers *Ends reamed

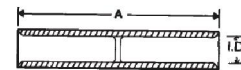

PART No.	DESCRIPTION	mm A	PART No.	DESCRIPTION	mm A
CKB10	Barrier Link 10mm ²	48	CKB120	Barrier Link 120mm ²	65
CKB16	Barrier Link 16mm ²	44	CKB150	Barrier Link 150mm ²	65
CKB20	Barrier Link 20mm ²	44	CKB185	Barrier Link 185mm ²	65
CKB25	Barrier Link 25mm ²	48	CKB240	Barrier Link 240mm ²	76
CKB35	Barrier Link 35mm ²	48	CKB300	Barrier Link 300mm ²	76
CKB70	Barrier Link 70mm ²	54	CKB400	Barrier Link 400mm ²	89
CKB95	Barrier Link 95mm ²	51	CKB500	Barrier Link 500mm ²	145
			CKB630	Barrier Link 630mm ²	145

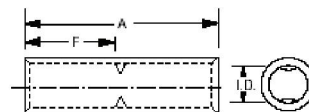
COPPER CABLE LINKS

PART No.	CAT No.	CABLE SIZE mm ²	STRANDING METRIC	DIMENSIONS mm ²		NO. CRIMPS (TOOL NO.)							CRIMP DIE
				A	I.D.	00	18	20	21	22	38A	40B	
CK0.5	H1451	0.5	1/0.80	22	2.1	2	-	-	-	-	-	-	38-44CU
CK02.5	H1467	2.5	7/0.67	22	2.5	2	-	-	-	-	-	-	
CK4	H1452	4	7/0.85	22	3.3	2	1	-	-	-	-	-	38-57CU
CK6	H1453	6	7/1.04	22	3.7	2	1	-	2	2	1	-	
CK10	H1454	10	7/1.35	22	4.7	2	1	-	2	2	1	-	38-63CU
CK16	H1455	16	7/1.70	44	5.5	-	3	2	2	2	1	-	
CK20	H1456	20	19/0.44	44	6.3	-	-	2	2	2	1	-	38-70CU
CK25	H1458	25	19/1.35	48	7.1	-	-	2	2	2	1	-	
CK35	H1488	35	19/1.53	48	8.4	-	-	2	2	2	1	-	38-92CU
CK50	H1460	50	19/1.78	48	9.5	-	-	2	2	2	1	-	
CK70	H1461	70	19/2.14	51	11.0	-	-	2	1	2	1	-	38-115CU
CK95	H1462	95	37/1.78	54	13.4	-	-	2	-	2	1	1	
CK120	H1492	120	37/2.03	65	15.5	-	-	-	-	2	2	1	38-165CU
CK150	H1493*	150	37/2.25	65	16.3	-	-	-	-	-	2	1	
CK185	H1494	185	37/2.52	65	18.4	-	-	-	-	-	2	1	38-200CU
CK240	H1495	240	61/2.25	89	21.2	-	-	-	-	-	3	1	
CK300	H1496	300	61.2.52	89	23.8	-	-	-	-	-	3	1	38-260CU
CK400	H1470	400	61/2.85	89	26.8	-	-	-	-	-	-	1	
CK500	H1471	500	61/3.20	114	30.0	-	-	-	-	-	-	2	40-281CU
CK630	H1499*	630	127/2.52	114	33.5	-	-	-	-	-	-	2	
CK800	H1474	800	127/2.85	230	39.3	-	-	-	-	-	-	3	40-310CU
CK1000	H1475	1000	127/3.20	230	43.8	-	-	-	-	-	-	3	

All sizes of crimp links are compatible with imperial size cables except those marked *

COPPER REDUCING LINKS



***Solid drawn copper rod**
***Electro tin plated *Stock sizes shown**

***Custom sizes made to order**
***Crimp with standard Utilux hex dies**

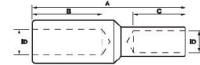

PART No.	DESCRIPTION	PART No.	DESCRIPTION
<u>REDUCING LINKS</u>			
CKR16-6	Reducing Link 16-6mm ²	CKR95-70	Reducing Link 95-70mm ²
CKR16-10	Reducing Link 16-10mm ²	CKR120-50	Reducing Link 120-50mm ²
CKR25-6	Reducing Link 25-6mm ²	CKR120-70	Reducing Link 120-70mm ²
CKR25-10	Reducing Link 25-10mm ²	CKR120-95	Reducing Link 120-95mm ²
CKR25-16	Reducing Link 25-16mm ²	CKR150-70	Reducing Link 150-70mm ²
CKR35-10	Reducing Link 35-10mm ²	CKR150-95	Reducing Link 150-95mm ²
CKR35-16	Reducing Link 35-16mm ²	CKR150-120	Reducing Link 150-120mm ²
CKR35-25	Reducing Link 35-25mm ²	CKR185-95	Reducing Link 185-95mm ²
CKR50-16	Reducing Link 50-16mm ²	CKR185-120	Reducing Link 185-120mm ²
CKR50-25	Reducing Link 50-25mm ²	CKR185-150	Reducing Link 185-150mm ²
CKR50-35	Reducing Link 50-35mm ²	CKR240-120	Reducing Link 240-120mm ²
CKR70-25	Reducing Link 70-25mm ²	CKR240-150	Reducing Link 240-150mm ²
CKR70-35	Reducing Link 70-35mm ²	CKR240-185	Reducing Link 240-185mm ²
CKR70-50	Reducing Link 70-50mm ²	CKR300-150	Reducing Link 300-150mm ²
CKR95-35	Reducing Link 95-35mm ²	CKR300-185	Reducing Link 300-185mm ²
CKR95-50	Reducing Link 95-50mm ²	CKR300-240	Reducing Link 300-240mm ²

COPPER STALK LUGS **Types 1 & 2**

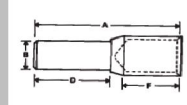

PART No.	DESCRIPTION	PART No.	DESCRIPTION
<u>TYPE 1 STALK LUGS</u>		<u>TYPE 2 STALK LUGS</u>	
CS1-35/8	Lug 35mm ² Stalk 8mm ²	CS2-16/8	Lug 16mm ² Stalk 8mm ²
CS1-50/8	Lug 50mm ² Stalk 8mm ²	CS2-16/10	Lug 16mm ² Stalk 10mm ²
CS1-70/10	Lug 70mm ² Stalk 10mm ²	CS2-25/10	Lug 25mm ² Stalk 10mm ²
CS1-95/10	Lug 95mm ² Stalk 10mm ²	CS2-25/16	Lug 25mm ² Stalk 16mm ²
CS1-120/16	Lug 120mm ² Stalk 16mm ²	CS2-35/10	Lug 35mm ² Stalk 10mm ²
CS1-150/16	Lug 150mm ² Stalk 16mm ²	CS2-35/12	Lug 35mm ² Stalk 12mm ²
CS1-185/12	Lug 185mm ² Stalk 12mm ²	CS2-35/16	Lug 35mm ² Stalk 16mm ²
CS1-185/16	Lug 185mm ² Stalk 16mm ²	CS2-50/10	Lug 50mm ² Stalk 10mm ²
		CS2-50/16	Lug 50mm ² Stalk 16mm ²
		CS2-70/16	Lug 70mm ² Stalk 16mm ²
		CS2-95/16	Lug 95mm ² Stalk 16mm ²

SEALED COPPER CRIMP LUGS



- *Long barrel length for effective heat shrink sealing
- *Designed for outdoor terminations
- *Solder sealed * Impervious to air at 140kPa min
- *For use with HV terminations

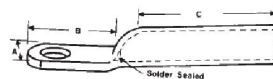

PART No.	CAT No.	CONDUCTOR SIZE mm ²	STUD HOLE SIZES AVAILABLE	CRIMPING DIE
SEG25	H16011,2	25	M8, M10	38-77CU
SEG35	H16014,5,6	35	M8, M10, M12	38-92CU
SEG50	H16018,9	50	M10, M12	38-104CU
SEG70	H16021,2	70	M10, M12	38-115CU
SEG95	H16023,4	95	M10, M12	38-142CU
SEG120	H16026,7,8	120	M10, M12, M16	38/40-165CU
SEG150	H16029,30	150	M12, M16	38/40-183CU
SEG185	H16032,3	185	M12, M16	38/40-200CU
SEG240	H16035,6	240	MB, M12	38/40-231CU
SEG300	H16038,9	300	MB, M16	38/40-260CU
SEG400	H16041,2	400	MB, M16	40/66-281CU
SEG500	H16044,5	500	MB, M20	40/66-310CU
SEG630	H16047,8	630	MB, M20	40-370CU

CABLE LUG SOLDER TYPE



- *Solid drawn copper tube * Electro tinned
- *Alternative sizes made to order
- *Not recommended for crimping
- *Bright acid tin finish for easy solder-ability

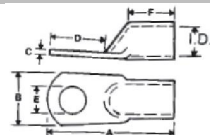

PART No.	CAT No.	MAX AREA SIZE mm ²	STUD HOLE SIZE	NOM. AMPS FOR CU CABLE	A	B	C	D	F	I.D.
SG10	H201	10	M5	75	28.6	8.9	1.8	8.9	9.5	4.5
SG16	H202	16	M6	99	38.6	11.9	1.6	16.0	17.0	6.1
SG35	H203	25-35	M8	155	38.1	16.0	1.8	16.5	12.7	9.3
SG50	H204	50	M10	250	44.5	18.5	2.4	20.5	15.9	10.3
SG70	H205	70	M10	310	56.0	23.1	3.3	27.5	17.9	12.6
SG95	H206	95-120	M12	375	68.0	28.0	3.3	33.5	20.6	15.8
SG120	H207	150	M16	435	79.5	33.0	3.3	36.0	22.2	19.0
SG150	H208	185	M20	570	85.7	37.6	4.0	36.0	28.6	21.3
SG185	H209	240-300	M20	680	106.5	46.5	5.3	28.0	37.0	26.5

LONG PALM LONG BARREL COPPER CRIMP LUGS



- *Long barrel length for effective heat shrink sealing
- *No inspection
- *Use same crimp tools as standard copper lugs
- *Long palm allows two bolt connection to be made

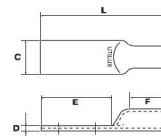

PART No.	CABLE SIZE mm ²	STUD HOLE SIZE	C	D	E	F	L	CRIMPING DIE
CG16LP	16	MB	13	1.9	70	40	114	38-63CU
CG25LP	25	MB	17	1.9	70	40	115	38-77CU
CG35LP	35	MB	18	2.7	90	45	140	38-92CU
CG50LP	50	MB	21	2.8	100	50	160	38-104CU
CG70LP	70	MB	21	3.2	100	50	160	38-115CU
CG95LP	95	MB	25	4.0	100	50	160	38-142CU
CG120LP	120	MB	30	4.8	100	50	160	38-165CU
CG150LP	150	MB	34	5.4	100	50	170	38-183CU
CG185LP	185	MB	37	5.4	100	55	170	38-200CU
CG240LP	240	MB	42	7.1	110	90	190	38-231CU
CG300LP	300	MB	46	7.9	110	90	190	40-260CU
CG400LP	400	MB	50	7.9	110	70	210	40-281CU
CG500LP	500	MB	55	8.2	110	70	210	40-310CU
CG630LP	630	MB	64	11.5	100	70	205	40-370CU

BOLTED CABLE LUG



- *Quick and easy termination
- *Re-usable
- *Palms are machined flat & parallel for maximum conductivity
- *Copper Alloy

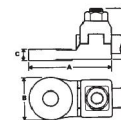

PART No.	CAT No.	MAX AREA SIZE mm ²	STUD SIZE	NON FLEXIBLE CONDUCTOR SIZES	PACK QTY
BG1	H1801	4-10	M6	7/.085, 7/1.04, 7/1.35	10
BG2	H1802	16	M8	7/1.70	10
BG3	H1803	25-35	M10	7/2.14, 19/1.53	10
BG3A	H1803A	25-35	M12	7/2.14, 19/1.53	10
BG4	H1804	50-70	M12	19/1.78, 19/2.14	10
BG4C	H1804C	50-70	M12	19/1.78, 19/2.14	10
BG5	H1805	95	M12	37/1.78	10
BG6A	H1806A	120	M16	37/2.03	10
BG6	H1806	150-185	M16	37/2.25, 37/2.52	10
BG7	H1807	185-240	M20	61/2.25	10
BG8	H1808	300-400	M20	61/2.52, 61/2.85	5
BG9	H1809	500	M20	61/3.20	5

'C' CONNECTORS



C-Connectors are manufactured in a 'C' shaped copper section for connection to main & tap copper conductors

*Reliability is ensured by passing tests specified by JIS C 2810

*Tin plated * Suitable for connecting copper conductors indoor & outdoor in applications such as earth grids

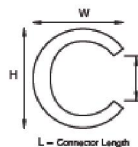

PART No.	CAT No.	CONDUCTOR RANGE mm ²	DEMENSIONS				INSUL COVER	DIE PART No.
			H	W	L	C		
CC10	T-011	7.5 - 11	9	6	12	5	-	#18C
CC16	T-016	11.5 - 16	12	8	13	5	-	#18C
CC20	T-020	14 - 20	13	10	13	5	T-020C	38-T020
CC25	T-026	21 - 26	15	11	16	6	T-026C	38-T026
CC35	T-044	27 - 24	19	14	20	8	T-044C	38-T044
CC50	T-060	45 - 60	21	15	22	10	T-060C	38-T060
CC70	T-076	61 - 76	24	17	22	11	T-076C	38-T076
CC95	T-098	77 - 98	28	19	25	14	T-098C	38-T098
CC120	T-122	99 - 122	30	21	26	13	T-122C	38-T122
CC150	T-154	123 - 154	34	24	28	17	T-154C	38-T154
CC185	T-190	155 - 190	37	25	35	17	T-190C	38-T190
CC240	T-240	191 - 240	40	28	40	19	T-240C	38-T240
CC300	T-288	241 - 288	45	31	45	22	T-288C	38-T288
CC400	T-365	289 - 365	48	34	50	24	T-365C	38-T365

SOLID PALM COPPER LUGS



These lugs are fabricated from copper rod to maximise the strength. They are made without a seam in the palm, with increased wall thickness & electro-tin plated. The solid palm eliminates the ingress of water. Crimping has been rationalised to only two (2) sets of crimp dies for the entire range of these lugs.

Typical Applications

*Overhead connections for electrical distribution systems

*Railway electrification systems where vibration is present

Other sizes available on request

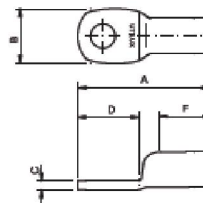

PART No.	CABLE SIZE mm ²	BOLT SIZE	A	B	C	D	E	CRIMP DIE
CG6SD	6	M6, M8, M10	51	16	4.2	21	23	38-77CU
CG10SD	10	M6, M8, M10	51	16	4.2	21	23	38-77CU
CG16SD	16	M8, M10, M12	70	21	6.0	27	30	38-104CU
CG25SD	25	M10, M12	70	21	6.0	27	30	38-104CU
CG35SD	35	M10, M12	70	21	6.0	27	30	38-104CU

ALUMINIUM LUGS



- *99.9% pure high conductive aluminium
- *forged from solid AL billets
- *Solid palm, therefore eliminating the ingress of moisture
- *Pre-filled with joining compound
- *Individually packed in sealed plastic bags

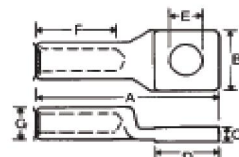

PART No.	CABLE SIZE mm ²	STUD SIZES - E	A	B	C	D	F	G	CRIMPING DIE
AG6	6	M6, MB	54	18	5	22	32	3.5	38-90AL
AG10	10	M10, MB	65	22	5	22	32	4.5	
AG16	16	M10, MB	65	22	5	22	32	5.5	
AG25	25	M10, MB	65	22	5	22	32	7.0	
AG35	35	M10, MB	65	22	5	22	32	8.5	
AG50	50	M10, MB	73	26	8	28	32	9.5	38-132AL
AG70	70	M10, M12, MB	73	26	8	28	32	11.0	
AG95	95	M10, M12, MB	80	30	10	35	32	13.0	38-173AL
AG120	120	M10, M12, MB	80	30	10	35	32	15.0	40-172AL
AG150	150	M10, M12, M16, MB	90	36	11	36	30	16.5	38-220AL
AG185	185	M12, M16, MB	90	36	11	36	30	18.5	40-220AL
AG240	240	M12, M16, MB	115	46	12	50	41	21.0	38-284AL
AG300	300	M12, M16, MB	115	46	12	50	41	23.5	40-283AL
AG400	400	M12, M16, MB	150	54	15	54	68	26.5	40-390AL
AG500	500	M12, M16, MB	150	54	15	54	68	29.5	
AG630	630	M16, MB	159	60	15	60	68	33.5	40-432AL

ALUMINIUM CRIMP LINKS



- *Solid barrier
- *High conductivity aluminium
- *Prefilled with jointing compound
- *Individually packed in sealed plastic bags

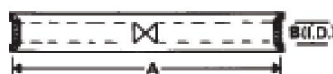

PART No.	CAT No.	CABLE SIZE mm ²	STRANDING METRIC	A	B	CRIMPING DIE
AK6	H15200	6	7/1.04	70	3.5	38-90AL
AK10	H15201	10	7/1.35	70	4.5	
AK16	H15202	16	7/1.70	70	5.5	
AK25	H15203	25	7/2.14 - 19/1.35	70	7	
AK35	H15204	35	19/1.53	70	8.5	
AK50	H15205	50	19/1.78	70	9.5	38-132AL
AK70	H15206	70	19/2.14	70	11	
AK95	H15207	95	19/2.52 - 37/1.78	124	13	38-173AL
AK120	H15208	120	37/2.03	124	15	40-172AL
AK150	H15209	150	37/2.25	124	16.5	38-220AL
AK185	H15210	185	37/2.52	124	18.5	40-220AL
AK240	H15211	240	61/2.25	124	21	38-284AL
AK300	H15212	300	61/2.52	124	23.5	40-283AL
AK400	H15213	400	61/2.85	146	26.5	40-390AL
AK500	H15214	500	61/3.20	146	29.5	
AK630	H15215	630	127/2.52	146	33.5	40-432AL
AK800	H15216	800	127/2.85	260	38.5	

ALUMINIUM 3 & 4 CORE SECTOR LUGS



- *Clear markings on barrel to indicate correct crimping sequence
- *Prefilled with jointing compound
- *Supplied with flat washers
- *Suit 3 core 120° & 4 core 90° solid sector aluminium conductor
- *99.9% pure, high conductivity aluminium
- *Individually packed in sealed plastic bags

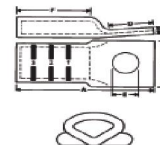

PART No.	CONDUCTOR SIZE mm ²	STUD SIZE	DIMENSIONS mm					TOOL No.	NEST	DIES IN- IDENT
			A	B	C	D	F			
3 CORE										
AGS120	120	M12	100	31	6.9	33.5	51	38A	12	16
AGS150	150	M12	103	35	7.3	33.5	51	38A	12	17
AGS185	185	M12	115	38	7.3	37.3	59	38A	12	18
AGS240	240	M12, M16	123	42	8.7	37.3	63	38A	12	19
4 CORE										
AGI120	120	MB	102	32	6.7	34.9	53.9	38A	14	16
AGI150	150	MB	110	35	7.1	34.9	59.5	38A	14	17
AGI185	185	MB	115	40	8.3	38.1	59.5	38A	14	18
AGI240	240	MB	128	46	11.7	44.4	62	38A	15	19

ALUMINIUM ROUND BARREL 4 CORE SECTOR LUGS



- *99.9% pure high conductivity aluminium
- *Forged from solid AL Billets
- *Solid palm, therefore eliminating the ingress of moisture
- *Pre-filled with joining compound
- *Individually packed in sealed plastic bags
- *Hexcrimp with std Utilux dies

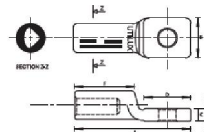

PART No.	CONDUCTOR SIZE mm ²	STUD SIZE	DIMENSIONS mm					AL HEX 38-	AL DIE 40-
			A	B	C	D	F		
AG4H185	185	M12	115	36	11	36	62	220AL	220AL
AG4H240	240	M12	133	36	12	36	62	284AL	283AL

ALUMINIUM 3 & 4 CORE SECTOR CRIMP LINKS

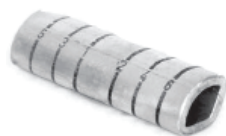

- Suitable for aluminium to copper in line terminations
- Friction Welded
- Manufactured from high purity copper & aluminium rod
- Prefilled With Jointing Compound
- Individually Packed In Sealed Plastic Bags

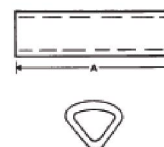

PART No.	CAT No.	CONDUCTOR SIZE mm ²	mm A	TOOL No.	NEST	DIES INDENT
3 CORE						
AKS120	H8627	120	90	38A	12	16
AKS150	H8628	150	90	38A	12	17
AKS185	H8629	185	105	38A	12	18
AKS240	H8630	240	110	38A	12	19
4 CORE						
AKI120	H8949	120	88.9	38A	14	16
AKI150	H8950	150	104.8	38A	14	17
AKI185	H8951	185	104.8	38A	14	18
AKI240	H8952	240	114.3	38A	15	19

ALUMINIUM SECTOR TO ROUND LINK

- *Clear markings on barrel to indicate correct crimping sequence
- *Prefilled with jointing compound
- *Suit 3 core 120° & 4 core 90° solid sector aluminium conductor
- *99.9% pure, high conductivity aluminium
- *Individually packed in sealed plastic bags

PART No.	SECTOR SIZE mm ²	ROUND SIZE mm ²	OVERALL LENGTH	ROUND HEX DIE	SECTOR CRIMP	
					NEST DIE	INDENT DIE
3 CORE						
AK3I185240	185	240	150	38-284AL	#12 NEST	#18 INDENT
AK3I240300	240	300	150	38-284AL	#15 NEST	#20 INDENT
4 CORE						
AGI120	240	300	153	38-284AL	#15 NEST	#20 INDENT

ALUMINIUM CCT CONDUCTOR (LUGS & LINKS)

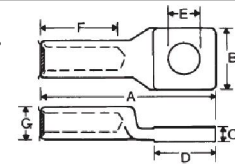

- *Aluminium lugs & links for 7/2.75 (40mm²) aluminium CCT conductors
- *99.9% pure high conductivity aluminium *Forged from solid AL Billets
- *Solid palm, therefore eliminating the ingress of moisture
- *Pre-filled with jointing compound
- *Individually packed in sealed plastic bags



PART No.	CABLE SIZE mm ²	TYPE	DIMENSIONS mm						CRIMPING DIE
			A	B	C	D	E	F	
AG40M10ET	40	LUG	73	26	8	28	M12	32	38-123AL
AG40M12ET	40	LUG	70	26	8	28	M12	32	38-132AL
AK4012ET	40	LINK	70	N/A	N/A	N/A	N/A	N/A	38-123AL

ALUMINIUM ROTATING LUGS

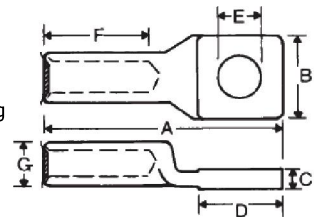
- *The lug can be rotated to any desired position
- *No need to twist conductor to correct orientation
- *Reduces total connection time
- *Suits solid & stranded conductor types
- *No need to round the cable first
- *Uses standard size hex dies *No voids when crimping
- *Takes two crimps on the barrel without overlapping
- *Palm will fit most receptacles found in URD system
- *Prefilled With Jointing Compound
- *Individually Packed In Sealed Plastic Bags
- *Made from high conductivity, high strength, solid forged aluminium



PART No.	CAT No.	CABLE SIZE mm ²	A	F	OD	B	C	D	STUD E	CRIMP DIE
AG4HR240MB	H15356	240	112	50	34	36	12	50	MB	
AG4HR240M12	H15357	240	112	50	34	36	12	50	M12	38-284AL
AG4HR240M16	H15358	240	112	50	34	36	12	50	M16	

BI-METAL LUGS



- *Friction welded
- *Pre-filled with jointing compound
- *Manufactured from high purity copper and aluminium rod
- *Individually packed in sealed plastic bags

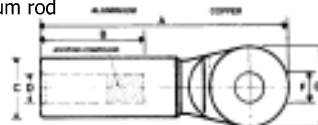

PART No.	CONDUCTOR SIZE mm ²	BARREL LENGTH	HOLE SIZES AVAILABLE in mm	PALM WIDTH
BG25	25	32mm	M10, MB	22mm
BG35	35	32mm	M10, M12, MB	22mm
BG50	50	32mm	M10, M12, MB	22mm
BG70	70	32mm	M10, M12, MB	22mm
BG95	95	60mm	M10, M12, MB	32mm
BG120	120	60mm	M12, M16, MB	32mm
BG150	150	60mm	M12, M16, MB	36mm
BG185	185	60mm	M12, M16, MB	36mm
BG240	240	60mm	M12, M16, MB	42mm
BG300	300	60mm	M12, MB	42mm
BG400	400	70mm	MB (Blank)	50mm
BG500	500	70mm	MB (Blank)	50mm
BG630	630	70mm	MB (Blank)	60mm

BI-METALCRIMP LINKS



- *Suitable for aluminium to copper in line terminations
- *Friction Welded
- *Manufactured from high purity copper & aluminium rod
- *Prefilled With Jointing Compound
- *Individually Packed In Sealed Plastic Bags

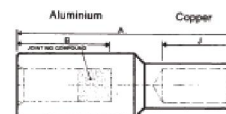

PART No.	CONDUCTOR SIZE mm ²	OVERALL LENGTH	AL-BARREL LENGTH	CU-BARREL LENGTH
BK16/16	16/16	70mm	32mm	21.5mm
BK25/25	25/25	70mm	32mm	21.5mm
BK35/35	35/35	70mm	32mm	21.5mm
BK50/50	50/50	70mm	32mm	21.5mm
BK70/70	70/70	70mm	32mm	21.5mm
BK95/95	95/95	120mm	60mm	40mm
BK120/120	120/120	120mm	60mm	40mm
BK150/150	150/150	120mm	60mm	40mm
BK185/185	185/185	120mm	60mm	40mm
BK240/240	240/240	125mm	60mm	40mm
BK300/300	300/300	125mm	60mm	40mm
BK400/400	400/400	155mm	70mm	58mm
BK500/500	500/500	155mm	70mm	58mm
BK630/630	630/630	160mm	70mm	60mm

Also available in reducing links

BI-METAL LUG (Solid) 3 & 4 CORE SECTOR LUGS



- *Clear markings on barrel to indicate correct crimping sequence
- *Prefilled with jointing compound
- *Supplied with flat washers
- *Suit 3 core 120° & 4 core 90° solid sector aluminium conductor
- *99.9% pure, high conductivity aluminium
- *Individually packed in sealed plastic bags

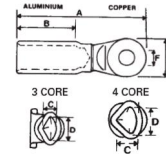

PART No.	CONDUCTOR SIZE mm ²	STUD SIZE F	DEMENSIONS mm					PALM THICK	#38A DIES	
			A	B	C	D	E		NEST	INDENT
3 CORE										
BGS120	120	MB, M12	111	49	10.6	18.1	32	6.0	12	16
BGS150	150	MB, M12	116	49	11.8	20.1	36	7.0	12	17
BGS185	185	MB, M12	126	57	13.2	22.5	36	7.0	12	18
BGS240	240	MB, M12, M16	138	61	15.2	25.8	42	7.0	12	19
BGS300	300	MB	147	61	19.4	27.2	42	7.0	12	21
4 CORE										
BGI120	120	MB, M12	111	49	12.1	17.1	32	6.0	14	16
BGI185	185	MB, M16	126	57	15.1	21.2	36	7.0	14	18
BGI240	240	MB, M16	136	61	17.5	24.6	42	7.0	14	19
BGI300	300	MB, M16	147	61	19.4	27.2	42	7.0	15	21

BI-METAL (Solid) 3 & 4 CORE SECTOR CRIMP LINKS



- *Suitable for 3 & 4 core solid sector cable
- *Clear markings on the barrel indicate the crimping sequence
- *Prefilled With Jointing Compound
- *Individually Packed In Sealed Plastic Bags
- *Friction Welded
- *For aluminium to copper in line terminations
- *Manufactured from high purity copper & aluminium rod

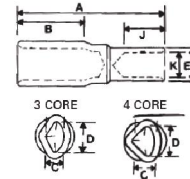

PART No.	CAT No.	ALUMINIUM					COPPER						
		CABLE SIZE mm ²	#38 DIES		A	B	C	D	E	J	K	CABLE SIZE mm ²	CRIMP DIES
			NEST	INDENT									
3 CORE													
BKS120/70	H15710	120	12	16	106	49	10.6	18.1	14.5	32	11.0	70	38-115CU
BKS120/120	H15711	120	12	16	116	49	10.6	18.1	20.5	40	15.0	120	38-165CU
BKS150/95	H15712	150	12	17	116	49	11.8	20.1	20.5	40	13.0	95	38-165CU
BKS150/150	H15713	150	12	17	116	49	11.8	20.1	24.5	40	16.5	150	38-200CU
BKS185/120	H15714	185	12	18	126	57	13.2	22.5	20.5	40	15.0	120	38-165CU
BKS185/185	H15715	185	12	18	126	57	13.2	22.5	24.5	40	18.5	185	38-200CU
BKS240/150	H15716	240	12	19	131	61	15.2	25.8	24.5	40	16.5	150	38-200CU
BKS240/240	H15717	240	12	19	131	61	15.2	25.8	32.0	40	21.0	240	38-260CU
4 CORE													
BKI70/50	H15756	70	14	14	88	43	9.0	13.5	14.5	22	9.5	50	38-115CU
BKI70/70	H15757	70	14	14	88	42	9.0	13.5	14.5	22	11.0	70	38-115CU
BKI95/70	H15758	95	14	15	106	49	10.5	14.8	14.5	32	11.0	70	38-115CU
BKI95/95	H15759	95	14	15	116	49	10.5	14.8	20.5	40	13.0	95	38-165CU
BKI120/70	H15760	120	14	16	106	49	12.1	17.1	14.5	32	11.0	70	38-115CU
BKI120/120	H15761	120	14	16	116	49	12.1	17.1	20.5	40	15.0	120	38-165CU
BKI150/95	H15762	150	14	17	116	49	13.6	19.1	20.5	40	13.0	95	38-165CU
BKI150/150	H15763	150	14	17	116	49	13.6	19.1	24.5	40	16.5	150	38-200CU
BKI185/120	H15764	185	14	18	126	57	15.1	21.2	20.5	40	15.0	120	38-165CU
BKI185/185	H15765	185	14	18	126	57	15.1	21.2	24.5	40	18.5	185	38-200CU
BKI240/150	H15766	240	14	19	131	61	17.5	24.6	24.5	40	16.5	150	38-200CU
BKI240/240	H15767	240	14	19	134	61	17.5	24.6	32.0	40	21.0	240	38-260CU
BKI300/185	H15768	300	14	21	140	61	19.4	27.2	24.5	40	18.5	185	38-200CU
BKI300/300	H15769	300	14	21	143	61	19.4	27.2	32.0	40	23.5	300	38-260CU

BI-METAL CRIMP STALK LUG



- *Suitable for aluminium to copper terminations
- *Friction Welded
- *Manufactured from high purity copper & aluminium
- *Prefilled with jointing compound
- *Individually packed in sealed plastic bags

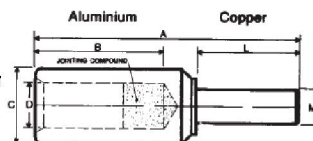

PART No.	CAT No.	CABLE SIZE mm ²	STRAND-ING MET- RIC	DEMENSIONS mm						CRIMPING DIE
				A	B	C	D	L	M	
BS16/12	H15502	16	7/1.70	70	32	12	5.5	30	12	38-90AL
BS25/12	H15503	25	19/1.35	70	32	12	7.0	30	12	
BS35/12	H15504	35	19/1.53	70	32	12	8.5	30	12	
BS50/12	H15505	50	19/1.78	70	32	16	9.5	30	12	38-132AL
BS70/12	H15506	70	19/2.14	70	32	16	11.0	30	12	
BS95/12	H15507	95	37/1.78	110	60	21.5	13.0	38	12	38-173AL 40-172AL
BS120/12	H15508	120	37/2.03	110	60	21.5	15.0	38	12	
BS120/14	H15509	120	37/2.03	110	60	21.5	15.0	28	14	
BS150/12	H15510	150	37/2.25	120	60	27	16.5	48	12	38-220AL 40-220AL
BS150/14	H15511	150	37/2.25	120	60	27	16.5	48	14	
BS185/16	H15512	185	37/2.52	120	60	27	18.5	48	16	
BS185/18	H15513	185	37/2.52	120	60	27	18.5	48	18	38-284AL 40-283AL
BS240/16	H15514	240	61/2.25	122	60	35	21.0	48	16	
BS240/18	H15515	240	61/2.25	122	60	35	21.0	48	18	
BS300/16	H15516	300	61/2.52	122	60	35	23.5	48	16	40-390AL
BS300/18	H15517	300	61/2.52	122	60	35	23.5	48	18	
BS400/18	H15518	400	61/2.85	153	70	47	26.5	65	18	
BS400/20	H15519	400	61/2.85	153	70	47	26.5	65	20	40-432AL
BS500/18	H15520	500	61/3.20	153	70	47	29.5	65	18	
BS500/20	H15521	500	61/3.20	153	70	47	29.5	65	20	
BS630/20	H15522	630	127/2.52	160	70	54	33.5	70	20	

BI-METAL (Solid) 3 & 4 CORE SECTOR STALK



- *Suitable for 3 & 4 core solid sector cable
- *Clear markings on the barrel indicate the crimping sequence
- *Prefilled With Jointing Compound
- *Individually Packed In Sealed Plastic Bags
- *Friction Welded
- *For aluminium to copper terminations
- *Manufactured from high purity copper & aluminium rod

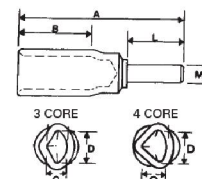

PART No.	CAT No.	CABLE SIZE mm ²	A	B	C	D	L	M	#38A DIES		
									NEST	INDENT	
3 CORE											
BSS240/16	H15816	240	134	61	15.2	25.8	48	16	13	19	
4 CORE											
BSI70/12	H15856	70	88	43	9.0	12.5	30	12	14	14	
BSI95/12	H15858	95	108	49	10.5	14.8	38	12	14	15	
BSI120/12	H15860	120	118	49	12.1	17.1	48	12	14	16	
BSI150/12	H15862	150	119	49	13.6	19.1	48	16	14	17	
BSI185/16	H15864	185	129	57	15.1	21.2	48	16	14	18	
BSI240/16	H15866	240	134	61	17.5	24.6	48	16	14	19	
BSI300/16	H15868	300	143	61	19.4	27.2	48	16	14	21	

BI-METAL LONG PALM LUGS



- *For two bolt termination applications *Blank palm, 150mm x 50mm
- *Friction welded high purity aluminium & copper rod
- *Clearly marked cable size, die recommendation & crimping position
- *Prefilled with jointing compound
- *Individually packed in sealed plastic bags
- *Palms can be drilled to customers bolt specification

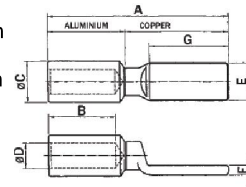

PART No.	CABLE SIZE mm ²	DIMENSIONS mm							CRIMPING DIE
		A	B	C	D	E	F	G	
BG240LPMB	240	209	60	35	21	50	13	105	38-284AL
BG300LPMB	300	209	60	35	23.5	50	13	105	
BG400LPMB	400	221	70	47	26.5	50	13	105	40-390AL
BG500LPMB	500	221	70	47	29.5	50	13	105	
BG630LPMB	630	221	70	54	33.5	50	13	105	40-432AL
BG800LPMB	800	266	105	54	39	50	13	105	

BI-METAL REVERSE LUGS



- *Used for connection of copper conductor to aluminium terminal
- *Blank aluminium palm & copper barrel
- *Friction welded high purity aluminium & copper rod
- *Clearly marked with crimping position
- *Pre-filled with jointing compound
- *Individually packed in sealed plastic bags

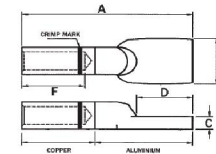

PART No.	CABLE SIZE mm ²	DEMENSIONS mm						CRIMPING DIE
		A	B	C	D	F		
BGRV25MB	25	70	23	4.5	24	22		38-92CU
BGRV35MB	35	70	22	4.5	24	22		
BGRV50MB	50	78	27	6.0	28	22		38-115CU
BGRV70MB	70	78	27	6.	28	22		
BGRV95MB	95	103	34	9.8	34	38		38-165CU
BGRV120MB	120	103	34	9.8	34	38		

BI-METAL ROTATING LUGS & LINK



- *The lug can be rotated to any desired position
- *No need to twist conductor to correct orientation
- *Reduces total connection time
- *Suits solid & stranded conductor types
- *No need to round the cable first
- *Uses standard size hex dies *No voids when crimping
- *Takes two crimps on the barrel without overlapping
- *Palm will fit most receptacles found in URD system
- *Prefilled With Jointing Compound
- *Individually Packed In Sealed Plastic Bags
- *Made from high conductivity, high strength, solid forged aluminium

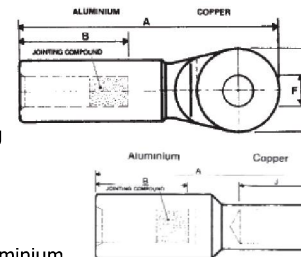

PART No.	CAT No.	CABLE SIZE mm ²	A	B	STUD F	CRIMP DIE	E	J	K	CRIMP DIE
BG4HR240MB	H15365	240	126	50	MB		42			
BG4HR240M12	H15357	240	126	50	M12		42			38-284AL
BG4HR240M16	H15358	240	126	50	M16		42			
BI-METAL ROTATING LINK			ALUMINIUM				COPPER			
BK4HR240150	4 CORE SECTOR	240-150	110	50		38-284AL	24.5	40	16.5	38-200CU