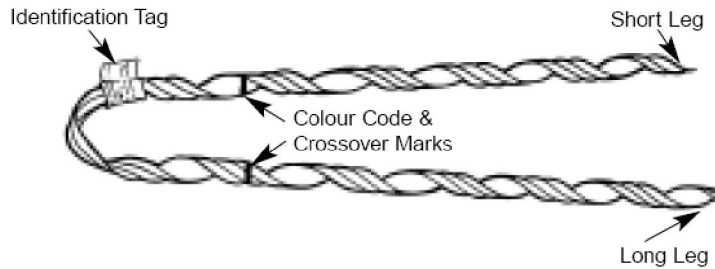
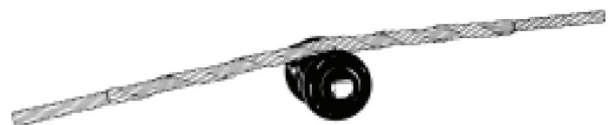

**OVERHEAD PRODUCTS****Preformed, helical, termination for overhead application**

Part no	Description
GFG-060	6 mm diameter, 7/7 construction, galvanised steel wire (SGG0600)
GFG-080-30	8 mm diameter, 6x19 (9/9/1), galvanised steel wire (Tifor)
GFG-113-LT-CL	11 mm diameter, Tifor wire, galvanised steel, 6x25 RHOL (SGG1125)
GFG-113-LT-CL	2 tonne "Parafil" (SCG1125)
CFG-105-8-CL	Trolley wire, 81 sq.mm or 0.126 sq.in. (CDE 1000D)
CFG-138	Trolley wire, 129 sq.mm. or 0.2 sq.in. (CDE 1375)
CFG-260-LT-CL	Feeder, 400 sq.mm. Cu, 91/2.36mm (CDE 2565)
CFG-235-CL	Feeder, 300 sq.mm. Cu, 61/2.62mm (CDE 2300)
CFG-183-CL	Feeder, 200 sq.mm.Cu, 37/2.62mm (CDE 1809)
AFG-293	Feeder, Al, 37/ 0.168" (ADE 2930)

**We also have a large range of other overhead products**

# OTHER RAIL RELATED PRODUCTS

WE ALSO HAVE A LARGE RANGE OF OTHER RAIL PRODUCTS



**RAIL DUCT**

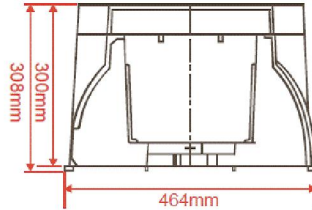

**HELIFORMED LINE FITTINGS  
INSULATORS  
LIVE LINE GLOVES  
OVER HEAD EQUIPMENT  
SUBSTATION FITTINGS  
EARTH RODS**



**STAKKABOX SECTIONAL  
ACCESS CHAMBERS**

