

Raychem

KGEL-IPCJNT

Insulation Piercing 4 & 5 core gel filled joint for pit & direct burial up to 1KV

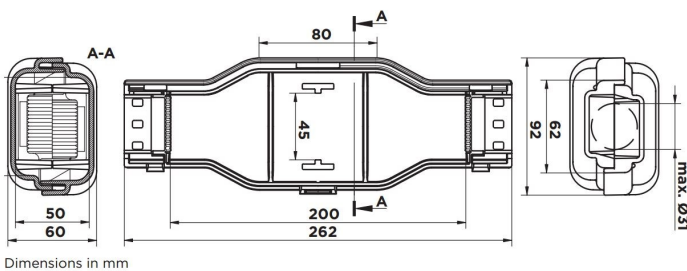

Excellent cold applied seal

The Raychem GelBox offers a state-of-the-art sealed joint for underground and direct-buried applications.

PowerGel sealing gel technology

The GelBox closure and the connector block, with their Revolutionary PowerGel sealing gel, cover and seal the joint quickly and easily, saving both time and effort. PowerGel sealing gel is rated to 90°C continuous temperature with an unlimited shelf life.

History

The GelBox joint is yet another one of Raychem's field-proven PowerGel filled products for the demanding requirements of the electrical power industry.

Capacity

The Raychem GelBox covers a wide application range of 4-core cables from 6 to 25mm² for both aluminium and copper conductors, stranded or solid and in addition 35mm² with round solid aluminium conductors. Size transitions or transitions from copper to aluminium are also possible.

Performance tests

The GelBox is qualified to CENELEC HD623, the European specification for buried applications. This includes a three week heat-cycling test with the joint immersed in one metre depth of water. A test report with detailed information is available on request.

Easy to install

Closing the rugged GelBox closure is literally a snap. No special tools needed, no rip cords to break, and no trimming, mixing, pouring, or heating is required. The GelBox can immediately be put into service.

Kit content

GelBox closure, connector block, 2 tie wraps and illustrated installation instruction.

Connector included

Easy to install connector block: No insulation cutback - insulation piercing technology. Shear bolts always guarantee the optimum contact force. Sealed core entries take care of possible water in between conductor strands. The connector block is fully qualified to IEC-61238-1. Test Report is available on request.

ORDERING OPTIONS	
Part Number:	Application Range:
KGEL-IPCJNT-01	4C X 6 - 25MM ² (Cu/Al rm/re) 4 X 6 - 35MM ² (Al/re)
KGEL-IPCJNT-02	5C X 6-16MM ²